

BRILLIANT

.....designed for protection and safety.



Infinity MKII

Made in
AUSTRALIA
By B&R Enclosures

A modular switchboard designed for commercial and residential applications.

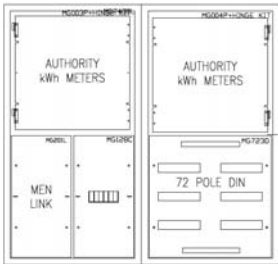

- Protection rating – IP55.
- Up to 160 Amp MCCB, 6 poles (not included).
- 72-pole DIN distribution.
- 2 x 610mm high x 610mm wide meter panel.
- Manufactured from:
 - 2.0mm thick marine grade aluminium (**3 only**)
 - 1.2mm mild steel (**1 only**)
- Powdercoated Grey White RAL9002.

XB-473155/1 (AL)
\$3800 EX GST
XB-473155/2 (Mild Stl)
~~\$9000~~ EX GST

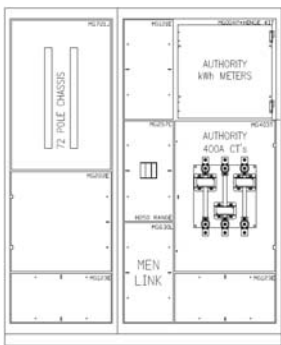

- Protection rating – IP55.
- Up to 250 Amp MCCB (not included).
- 72-pole chassis distribution.
- Manufactured from 1.2mm mild steel (**1 only**)
- Powdercoated Grey White RAL9002.

XB-473155/3
\$5600 EX GST

(Product not available in NSW)



- Protection rating – IP55.
- Up to 160 Amp MCCB, 18 poles (not included).
- 36-pole DIN distribution.
- 1 x 910mm high x 610mm wide meter panel.
- Manufactured from 1.2mm mild steel (**1 only**)
- Powdercoated X15 Orange.

XB-473155/4
\$2900 EX GST

Please note on ALL products:

- Additional accessories, if required, are sold separately subject to availability.
- Metalware assembled supply -- No functional devices, wiring or labels included