

# Field Cabinet Thermostat



Temperature range: 10°C to 60°C  
 Operating voltage: AC 230 V, 50/60 Hz  
 Contact: SPDT  
 Switching current: Heat 10 (4) A  
                           Cool 5 (2) A  
 Switching differential: approx 0.5 K  
 Housing protection: IP30/ isolated

Includes bracket for mounting to rail.



## ORDERING GUIDE

Dimensions (mm)

Part Number	Thermostat Only (mm)			Bracket Incl. (mm)		
	Height (A)	Width (B)	Depth (C)	Height (D)	Width (E)	Depth (F)
FCTHERM	75	75	20	100	75	35

## TECHNICAL DRAWINGS

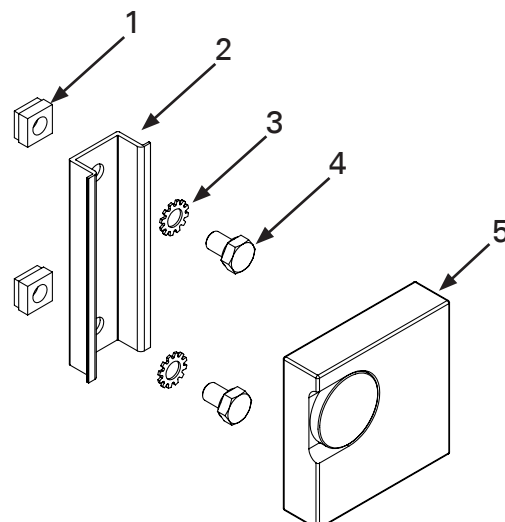
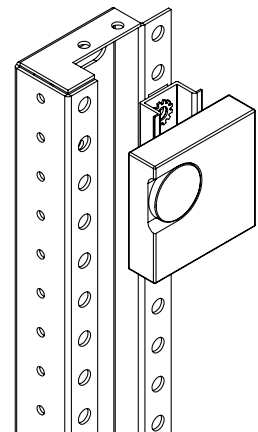
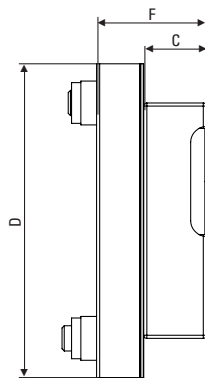
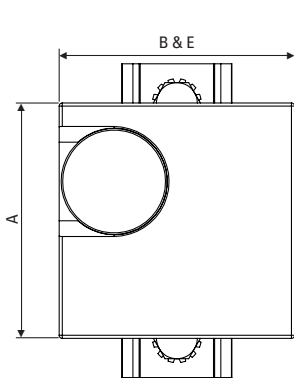

## ASSEMBLY GUIDE

Number	Description	Qty
1	Nut M8 Square Foam Back	2
2	Din Rail	1
3	Washer M8 EXT S/Proof ZP	2
4	Screw M8x12 Hex HD CR ZP	2
5	Thermostat Snap-In Type	1