

Lighting - LQLK

INCLUSIONS

(LQLK03/05)

- Mounting Brackets

(BRLED300/500)

- LED Light - 300mm or 500mm
- Power Supply
- Switch

(BRLEDK03/05)

- LED Light - 300mm or 500mm
- Splitter
- Corner Connector
- Straight Connector

(BRMOT)

- PIR sensor



iLINQ LQLK Light Kit Assembly Manual
 < OR Download

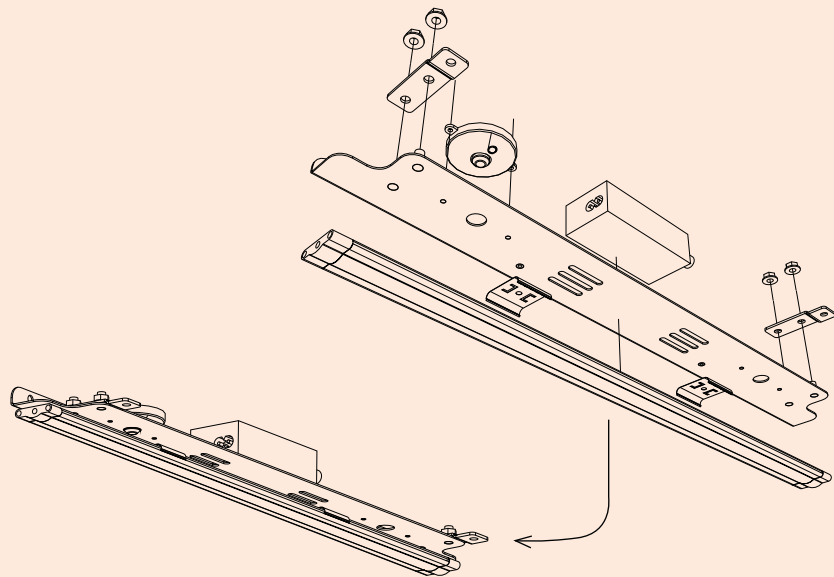

ADVANTAGE

- Allows for opening of full height swing frames or escutcheons when fitted
- PIR movement sensor for power efficiency on optional door switch
- Can be daisy changed for suites
- Mounted directly to 19" rack rails
- 300mm light = 280 (lm) lumens
- 500mm light = 460 (lm) lumens

MATERIALS

- Body – zinc coated steel
- Thickness – 1.6mm

FINISH

- Powdercoated Mist Blue (white)



DID YOU KNOW?

An optional PIR motion sensor is available with the iLINQ light kits. This sensor will activate the light when the enclosure is opened. Light will turn off when not in use.



Light Kit

LIGHT BRACKET

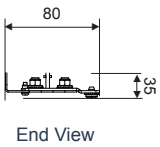
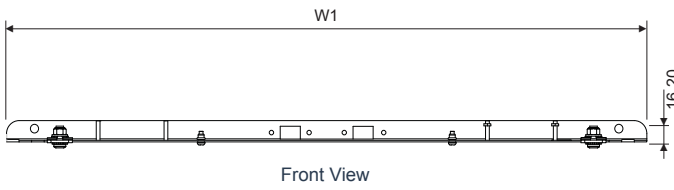
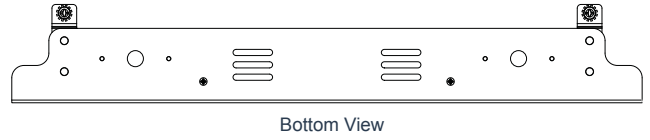
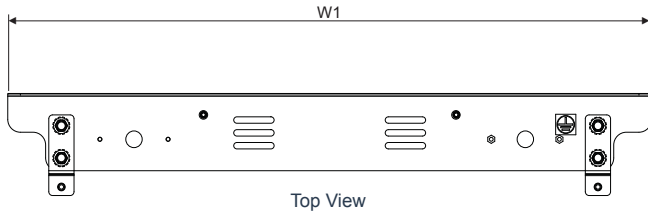

HELPFUL HINT:
BRLEDK05 and BRLEDK03
are required when daisy-
chaining lights together.

3.0 Assembled to Order

LIGHT SELECTION

Catalogue No.	Inclusions					Required Mounting Bracket		To suit enclosure	
	LED Light	Power Supply	Splitter	Switch	Connectors	LQLKB03	LQLKB05	Width (mm)	Optional
BRLED300	•	•		•		•		400	
BRLED500	•	•		•			•	600 & 800	BRMOT
BRLEDK03	•		•		•	•		400	PIR Motion Sensor
BRLEDK05	•		•		•		•	600 & 800mm	

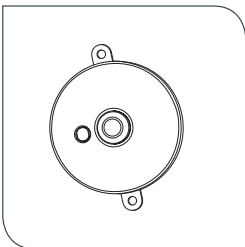

PIR Sensor

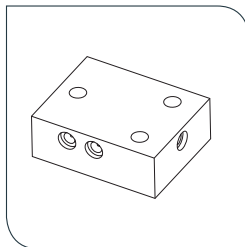

Splitter (up to 4 lights)

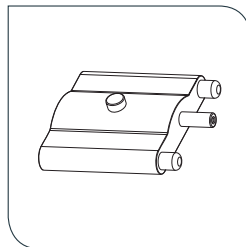

Switch

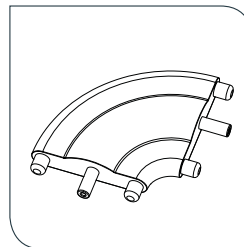

Corner Connector

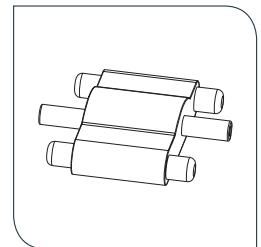

Straight Connector