

## RTBA – Aluminium

Round Ex d Enclosure – Zones 1&2, 21&22

### Index

[Dimension Sheet](#)

[Catalogue Information](#)

[Leaflet](#)

### Web Links

[RTBA Information Page](#)

[Ask a question / Send us an enquiry](#)

[Information about B&R](#)

[Local Sales Team Phone Numbers](#)



## Round Ex d Enclosure - RTBA85

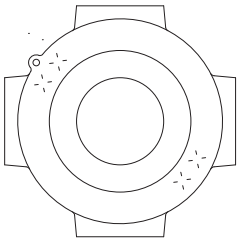

Front View

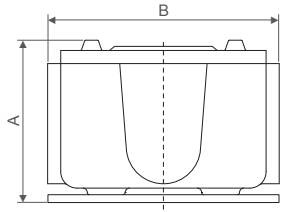

Side Section View

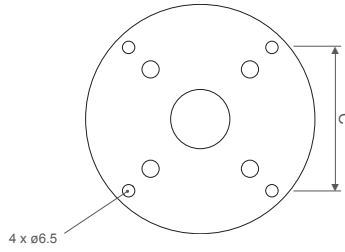

Side View

## Round Ex d Enclosure - RTSA88

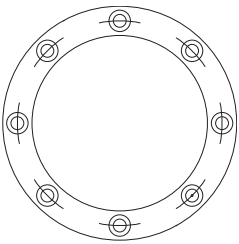

Front View

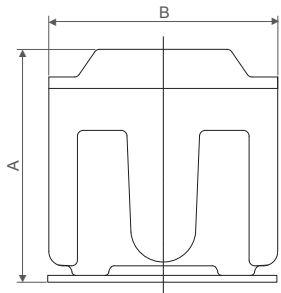

Side Section View

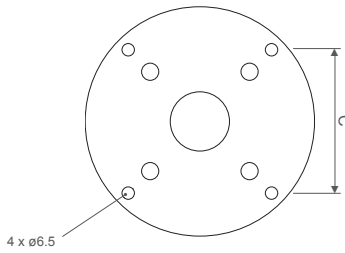

Side View

Catalogue No.	Dimensions (mm)		
	A	B	C
RTBA85	80	107	
RCSA85W	80	107	
RCBA88W	100	120	76
RTSA88	100	120	76



# RTBA – Aluminium Round Exd Enclosure – Zones 1 & 2, 21 & 22

brenclosures.com.au/rtba.htm

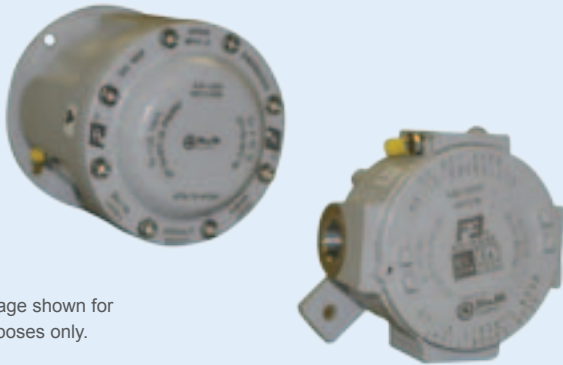

Disclaimer: Image shown for illustration purposes only.



Certification number: IECEx TSA 08.0040  
Range: RJB and SJB Series

## Features

- Certified for use in IIC and conductive dust applications
- Customised etched identification label
- Protection
  - Ex d IIC T6 -20°C<Ta<60°C Gb
  - Ex tb IIC T85°C -20°C<Ta<60°C Db
- Ambient temperature -20°C ~ + 60°C
- Conformity
  - IEC 60079-0, IEC 60079-7,
  - IEC 60079-31
- Materials
  - Body – marine grade copper-free aluminium alloy
  - Gasket – silicone
  - Fixings – 316 stainless steel
- Surface finish – protective coating
- Protection rating – IP66 and IP67

The round ex d enclosure is constructed from cast aluminium alloy and is suitable for use in hazardous areas with the most demanding conditions. These enclosures are designed to house terminals, control and signalling equipment and instruments in Zone 1 and 2, Zone 21 and 22 applications where flammable liquids, gases and vapours or combustible dusts are frequently present.

## Inclusions

- Choice of threaded or spigot lid
- Solid silicone seal
- Earth stud

## Selection Guide

### Round Ex d Enclosures Pre-configured

Catalogue No.	Internal Dimensions (mm)		Number of Entries	Position of Entries	Lid
	Diameter	Depth			
RTBA85/220N <sup>▲</sup>	80	50	2 x M20	Opposite Sides	Threaded
RTBA85/420X	80	50	4 x M20	1 per side	Threaded
RTBA85/225N <sup>▲</sup>	80	50	2 x M25	Opposite Sides	Threaded
RTBA85/425X <sup>▲</sup>	80	50	4 x M25	1 per side	Threaded
RTSA88/220N <sup>▲</sup>	80	80	2 x M20	Opposite Sides	Spigot
RTSA88/420X <sup>▲</sup>	80	80	4 x M20	1 per side	Spigot
RTSA88/225N <sup>▲</sup>	80	80	2 x M25	Opposite Sides	Spigot
RTSA88/425X <sup>▲</sup>	80	80	4 x M25	1 per side	Spigot

<sup>▲</sup> Available on request

The above enclosures can also be sold with controls and terminals fitted. Contact one of our sales engineers to discuss project requirements.

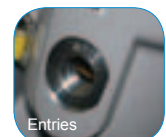

## RCSA Selection Guide

### Round Control Station – pre-configured

Catalogue No.	Internal Dimensions (mm)		Switch Type	Pole	Description	No of entries	Position of entries
	Diameter	Depth					
RCSA88S2P20/220N <sup>▲</sup>	80	80	Isolator Switch	2-p	20A 240V	2 x M20	opposite sides
RCSA88S2P25/425X <sup>▲</sup>	80	80		2-p	25A 240V	4 x M25	all 4 sides
RCSA88S2P25/420X <sup>▲</sup>	80	80		2-p	25A 240V	4 x M20	all 4 sides
RCSA88S2P25/225N <sup>▲</sup>	80	80		2-p	25A 240V	2 x M25	opposite sides
RCSA88S2P25/220N <sup>▲</sup>	80	80		2-p	25A 240V	2 x M20	opposite sides
RCSA88S2P25/125 <sup>▲</sup>	80	80		2-p	25A 240V	1 x M25	–
RCSA88S2P25/120 <sup>▲</sup>	80	80		2-p	25A 240V	1 x M20	–
RCSA88S2P32/225N <sup>▲</sup>	80	80		2-p	32A 240V	2 x M25	opposite sides
RCSA88S4P20/220N <sup>▲</sup>	80	80		4-p	20A 415V	2 x M20	opposite sides
RCSA88S4P25/225N <sup>▲</sup>	80	80		4-p	25A 415V	2 x M25	opposite sides
RCSA88S4P32/225N <sup>▲</sup>	80	80		4-p	32A 415V	2 x M25	opposite sides
RCSA88S1P3H/220N <sup>▲</sup>	80	80		1-p	( hand - off - auto )	2 x M20	opposite sides
RCSA88S1P3F/220N <sup>▲</sup>	80	80		1-p	( fwd - off - rev )	2 x M20	opposite sides
RCSA88S1P2M/220N <sup>▲</sup>	80	80		1-p	( man - auto )	2 x M20	opposite sides
RCSA88S2P2M/220N <sup>▲</sup>	80	80		2-p	( man - auto )	2 x M20	opposite sides
RCSA88S1P2L/220N <sup>▲</sup>	80	80		1-p	( 1 - 2 )	2 x M20	opposite sides
RCSA88S2P2L/220N <sup>▲</sup>	80	80	2-p	( 1 - 2 )	2 x M20	opposite sides	
RCSA88K1P2N/120 <sup>▲</sup>	80	80	Key Switch	1-p	Off-On, NO/NC changeover	1 x M20	opposite sides
RCSA88K1P2L/120 <sup>▲</sup>	80	80		1-p	1-2, NO/NC changeover	1 x M20	opposite sides
RCSA88R1P3H/220N <sup>▲</sup>	80	80	Rotary Button	1-p	( H - O - A )	2 x M20	opposite sides
RCSA88R1P3F/220N <sup>▲</sup>	80	80		1-p	( FOR )	2 x M20	opposite sides
RCSA88R1P2L/220N <sup>▲</sup>	80	80		1-p	( 1 - 2 )	2 x M20	opposite sides
RCSA88PB2P2N220N <sup>▲</sup>	80	80	Black Pushbutton	2-p	( on - off )	2 x M20	opposite sides
RCSA88PB2P2N/120 <sup>▲</sup>	80	80		2-p	( on - off )	1 x M20	–
RCSA88PE1P/120 <sup>▲</sup>	80	80	Emergency Stop	1-p	twist to reset	1 x M20	–
RCSA88PE1P/220N <sup>▲</sup>	80	80		1-p	twist to reset	2 x M20	opposite sides
RCSA88PR1P/120 <sup>▲</sup>	80	80	Pushbutton	1-p	Red	1 x M20	–
RCSA88PR1P/220N <sup>▲</sup>	80	80		1-p	Red	2 x M20	opposite sides
RCSA88PG1P/120 <sup>▲</sup>	80	80		1-p	Green	1 x M20	–
RCSA88PG1P/220N <sup>▲</sup>	80	80		1-p	Green	2 x M20	opposite sides
RCSA88PD/120 <sup>▲</sup>	80	80		–	Stop - Start	1 x M20	–
RCSA88PD/220N <sup>▲</sup>	80	80		–	Stop - Start	2 x M20	opposite sides
RCSA88PB1P/120 <sup>▲</sup>	80	80		1-p	Black	1 x M20	–
RCSA88LR240/220N <sup>▲</sup>	80	80		Pilot Light	–	Red, 240V	2 x M20
RCSA88LG240/220N <sup>▲</sup>	80	80	–		Green, 240V	2 x M20	–
RCSA85W <sup>▲</sup>	80	50	Window	–	Threaded lid	–	–
RCSA88W <sup>▲</sup>	80	80		–	Spigot lid	–	–

<sup>▲</sup> Available on request

The above enclosures are sold with controls and terminals fitted. Contact one of our sales engineers to discuss project requirements.

## Aluminium Round Ex d Enclosure

Ex d & Ex tb Protection

Zones 1 & 2, 21 & 22

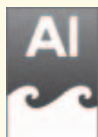

Protection: Ex d IIC T6 -20°C<Ta<60°C Gb  
Ex tb IIC T85°C -20°C<Ta<60°C Db

Ambient Temperature: -20°C ~ +60°C

Conformity: IEC 60079-0, IEC 60079-7, IEC 60079-31  
Certification number: IECEx TSA 08.0040  
Range: RJB and SJB Series



IP66/67

### OVERVIEW

**The round exd enclosures are made from cast aluminium alloy and are suitable for use in hazardous areas with the most demanding conditions.**

These enclosures are suitable for Zone 1 and 2, Zone 21 and 22 applications where flammable liquids, gases and vapours or combustible dusts are frequently present.

### MATERIALS

Body: Marine grade, copper-free aluminium alloy  
Gasket: Silicone  
Fixings: 316 stainless steel  
Surface finish: Protective coating

### APPLICATION

Designed to house terminals, control and signalling equipment and instruments in areas classified hazardous by the presence of flammable liquids, gases and vapours or combustible dusts.

### FEATURES

- IP66 and IP67 protection rating
- Certified for use in IIC hydrogen and conductive dust applications
- Customised etched identification label
- Solid silicone seal
- Threaded or spigot lid
- Earth stud
- Laser etched engraving
- Optional glass viewing window on cover

# ENCLOSURES AL ROUND EX d

## CATALOGUE INFO

Catalogue No.	Dimensions (mm)						Maximum No. of Entries			
	External Depth (H1)	External Width (W1)	Internal Diameter	Window Diameter	Internal Depth	Fixings (H2)	Fixings (W2)	Total	Per Side	Lid
RTBA85	80	107	80	–	50	110	–	4 x M25 or 4 x ¾" NPT	1	Threaded
RCSA85W	80	107	80	50	50	110	–	4 x M25 or 4 x ¾" NPT	1	Threaded
RCBA88W	100	120	80	50	80	76	76	8 x M25 or 8 x ¾" NPT	2	Threaded
RTSA88	100	120	80	–	80	76	76	8 x M25 or 8 x ¾" NPT	2	Spigot

The above enclosures can also be sold with controls and terminals fitted. Contact one of our sales engineers to discuss project requirements.

## TERMINAL BOX

Catalogue No	Internal Dimensions (mm)		Number of Entries	Position of Entries	Lid
	Diameter	Depth			
RTBA85/220N <sup>^</sup>	80	50	2 x M20	Opposite Sides	Threaded
RTBA85/420X	80	50	4 x M20	1 per side	Threaded
RTBA85/225N <sup>^</sup>	80	50	2 x M25	Opposite Sides	Threaded
RTBA85/425X <sup>^</sup>	80	50	4 x M25	1 per side	Threaded
RTBA88/220N <sup>^</sup>	80	80	2 x M20	Opposite Sides	Threaded
RTBA88/420X <sup>^</sup>	80	80	4 x M20	1 per side	Threaded
RTBA88/225N <sup>^</sup>	80	80	2 x M25	Opposite Sides	Threaded
RTBA88/425X <sup>^</sup>	80	80	4 x M25	1 per side	Threaded

<sup>^</sup> Available on request

## TECHNICAL DRAWINGS

Round Ex d Enclosure - RTBA85

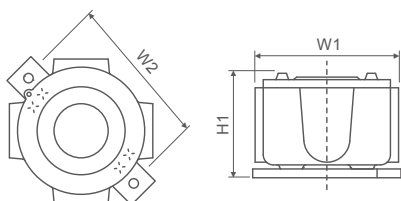

Round Ex d Enclosure - RTSA88

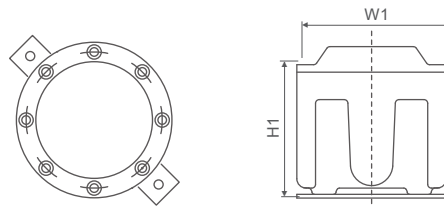

Other brands in the B&R Group:



**Queensland** P: +61 7 3714 1000  
**Townsville** P: +61 7 4775 6255  
**Sydney** P: +61 2 8867 7688  
**Newcastle** P: +61 2 4961 4433  
**Victoria** P: +61 3 8588 8400

**South Australia** P: +61 8 8417 6200  
**Western Australia** P: +61 8 9248 9744  
**Tasmania** P: +61 3 6331 5545  
**Northern Territory** P: +61 8 8947 0870

Email sales@brenclosures.com.au  
 Web www.brenclosures.com.au